

Ansell

SMART Pack

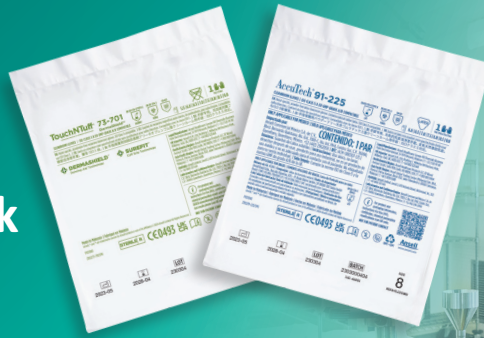

INNOVATION MEETS SUSTAINABILITY

Smaller packaging. Same trusted gloves.

Ansell's compact SMART Pack pouch design and automated packing process is focused on working better for you whilst having less impact on our planet.

Why SMART Pack?

- ✓ Inner wrap folding and insertion into SMART Pack pouch is automated to minimize human contact and reduce the risk of contamination
- ✓ SMART Pack pouch, inner and outer bags, and inner wrap are fully recyclable*
- ✓ Helmke Drum tested easy to peel open design produces zero particulates
- ✓ Pouch size reduced by 56% saving 20.4 tons of PE plastic per year**
- ✓ Removal of production barcode label: replaced with IPA resistant ink-jet printed production information across the top of the SMART Pack, reducing both the contamination risk and packaging materials
- ✓ Smaller pouches means smaller shipper cases resulting in additional capacity per shipping container, enabling more gloves per container ensuring efficient shipping and supply assurance
- ✓ Shipper case made from 100% recycled content cardboard and shipper case liner made from 30% recycled content HDPE



*Always check your local recyclable status of HDPE & LDPE as this plastic material may not be considered suitable for recycling in your country.

1 SMART FOR THE CLEANROOM

The packing of gloves into the SMART Pack pouch is automated to reduce the risk of contamination from human contact. The following packing processes are performed by machine:

1. Placing gloves onto inner wrap
2. Inner wrap folding
3. Inserting inner wrap into the SMART Pack pouch
4. SMART Pack Sealing

SMART Easy Peel Opening Method

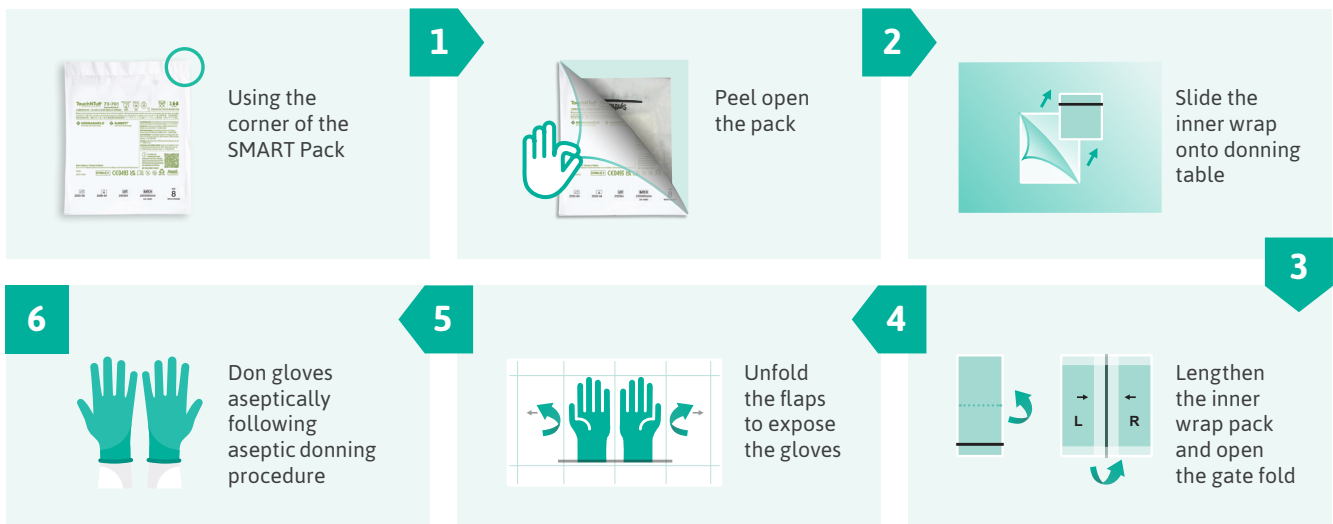

2

SMART FOR THE ENVIRONMENT

Smaller pouches, new packing configuration, smaller shipper cases mean



Less cardboard and plastics waste



Less transportation space required
i.e. less containers filled, less freight
ships and trucks used

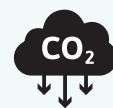

Reduced ecological footprint

In addition to this:



Shipper cases are made from 100% recycled material and are recyclable.
SMART Pack, inner and outer bags are made from HDPE or LDPE which can also
be recycled.*



*Always check your local recyclable status of HDPE & LDPE as this plastic material may not be considered suitable
for recycling in your country.

3

SMART SHIPPING

The 15% smaller and 30%[^] lighter shipper cases (still with the same number of pairs per box) means better shipping efficiencies and more gloves shipped to you per shipping container.

**CONTAINER CAPACITY INCREASE =
SHIPPING YOU MORE PRODUCT PER SHIPPING CONTAINER**

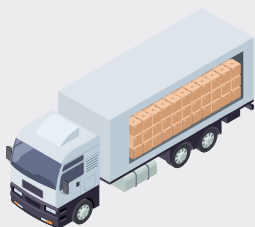

PREVIOUS packing
configuration:
152,000 glove pairs
per 20' container



NEW Packing
Configuration:
278,000 glove pairs
per 20' container

18% more pairs of gloves
shipped per 20' container**



**Based on FY22 sales volumes (73-701 & 91-225 only)

[^] Based on 73-701 current shipper case weight vs. 73-701 new shipper case weight

4 SMART SPACE SAVING

More SMART Pack shipper cases per standard and Euro pallet compared to current shipper case dimensions, enabling you to store more product in your warehouse in the same size space.

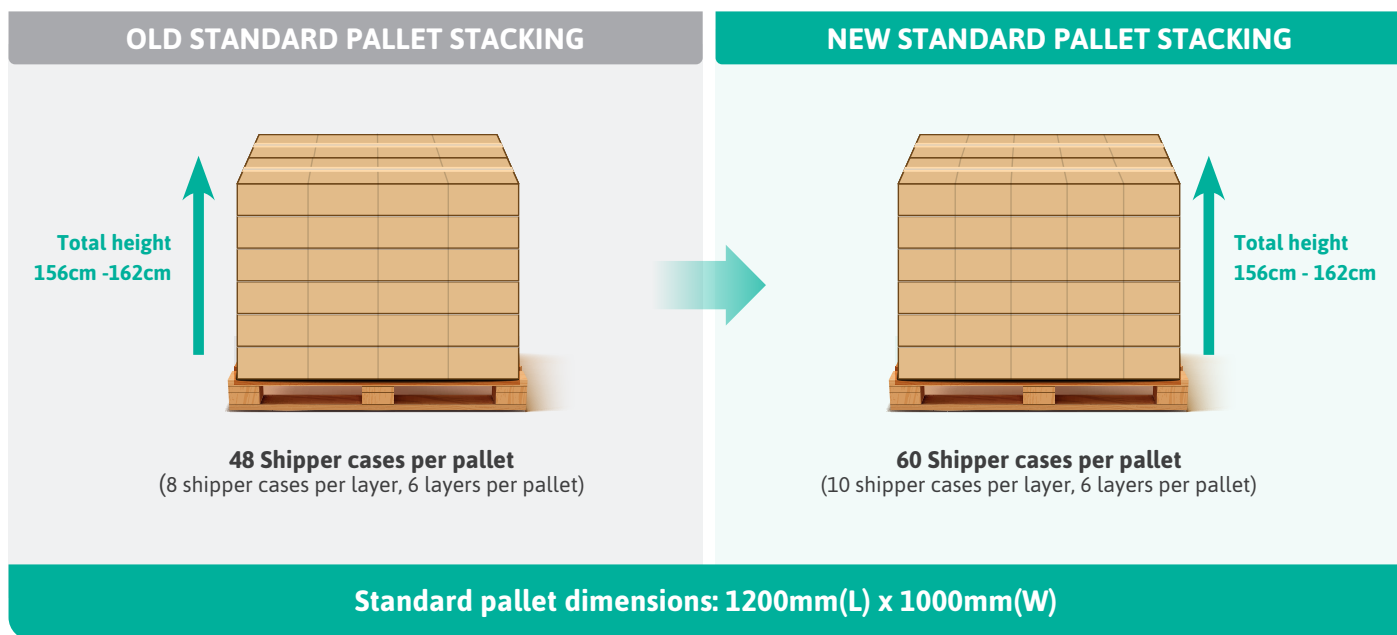

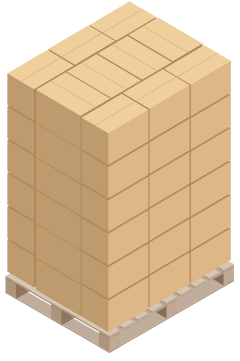
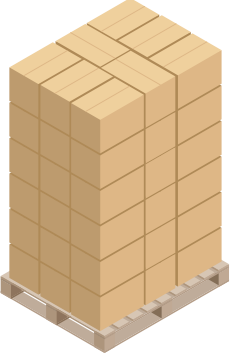
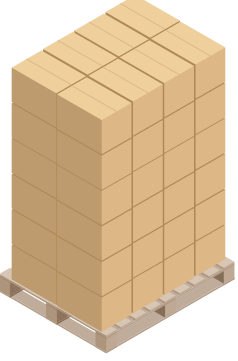
	73-701 & 91-225 SMART Pack	TouchNTuff® 73-701 Long Pack	AccuTech® 91-225 Long Pack
Shipper dimension	395mm(L) x 275mm(W) x 260mm(H)	420mm(L) x 300mm(W) x 260mm(H)	455mm(L) x 293mm(W) x 260mm(H)
Shipper volume	0.028m ³	0.033m ³	0.0035m ³
Shipper per layer	10	8	8
Number of layers	6	6	6
Total shipper per pallet	60	48	48
Total shipper height	156cm - 162cm	156cm - 162cm	156cm - 162cm
Possible carton loading pattern (based on simulation)			

OLD EURO PALLET STACKING

Total height
156cm -162cm

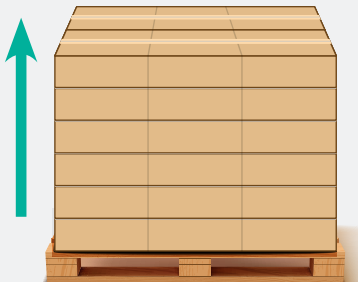

36 shipper cases per pallet
(6 shipper cases per layer, 6 layers per pallet)

NEW EURO PALLET STACKING

Total height
156cm - 162cm

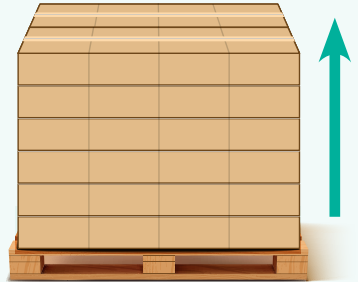

48 Shipper cases per pallet
(8 shipper cases per layer, 6 layers per pallet)

Euro pallet dimensions: 1200mm(L) x 800mm(W)

	73-701 & 91-225 SMART Pack	TouchNTuff® 73-701 Long Pack	AccuTech® 91-225 Long Pack
Shipper dimension	395mm(L) x 275mm(W) x 260mm(H)	420mm(L) x 300mm(W) x 260mm(H)	455mm(L) x 293mm(W) x 260mm(H)
Shipper volume	0.028m³	0.033m³	0.0035m³
Shipper per layer	8	6	6
Number of layers	6	6	6
Total shipper per pallet	48	36	36
Total shipper height	156cm - 162cm	156cm - 162cm	156cm - 162cm
	